



LUCKY NUMBERS

LUCKY NUMBERS

Operation Manual (v1.0)

Software version: 2.2.0, display 2.1.6

MAGIC PLAY SP Z O.O.

CHOCIMSKA 6, 62800 KALISZ, POLAND

Phone/Fax: +48 62 753 21 88. e-mail: service@magicplay.pl

website: www.magicplay.eu

Serial number: _____

Distributor: _____

Date: _____



TABLE OF CONTENTS

1. PACKAGE CONTENTS	2
2. SPECIFICATIONS.....	4
2.1 MAIN COMPONENTS.....	5
3. SETUP & INSTALLATION	6
3.1 PLAY ZONE	6
3.2 CONNECTING POWER.....	6
4. IMPORTANT INFORMATION AND GAMEPLAY	7
4.1. SD CARD.....	7
4.3 PLAYFIELD AND GAMEPLAY	8
5. GAME OPTIONS	9
5.1 MENU ACCESS AND NAVIGATION	9
5.2 SERVICE MENU	10
6. MAINTENANCE, INSPECTION	11
6.1 SAFETY CHECK.....	11
7. TROUBLESHOOTING	11
8. TERMS OF WARRANTY	12



Thank You for purchasing LUCKY NUMBERS. We hope you enjoy the product. The manual contains valuable information about how to operate and maintain your game machine properly and safely. It is intended for the owner and/ or personnel in charge of product operation. Carefully read and understand the instructions.

If you need any help during instalation and setup please utilize this manual and troubleshooting guide. If the product fails to function properly, non-technical personnel should under no circumstance sttempt to service the machine. Contact your distributor or manufacturer for help.

READ BEFORE USE

INSPECT IMMEDIATELY AFTER TRANSPORTING THE PRODUCT

After receiving the shipment, inspect the product thoroughly to ensure that it has been shipped with care. Before turning the power on, please check the following:

- Check the cabinet for damage or shifting that may have occurred during shipping. Are there any dented portions or defects (cuts, etc.) on the external surfaces of the cabinet?
- Are all the legs and adjusters/levelers/feet intact?
- Do the power supply voltage and frequency requirements meet with those of the location (110V/220V)?
- Are all wires linked correctly and securely connected to each other? If coupled in an incorrect manner, the connection will not be made accurately and it could cause not only irreparable damage to the machine, but also is a potential fire hazard. **DO NOT INSERT CONNECTORS FORCIBLY.**
- Check that the all the cables, including power cables, are undamaged. Do power cables or other wires have any splices, cuts, or dents?
- Have you been provided with all of the associated accessories?
- Can all doors/lids be opened with the accessory keys? Can doors/lids be firmly closed? Does the coin box key open the coin box(es)?

1. PACKAGE CONTENTS

Open the package and make sure all the items are included:

- 1 x Body Assembly
- Following accessories:

No.	Name	Qty.	Note
1	Marquee	1	
2	Keys	2 sets	
3	User's manual	1	
4			
5			

If any items are found missing, please contact your sales representative for help immediately.

NOTE: Part models are subject to change without notice.



IMPORTANT SAFETY INSTRUCTIONS

To ensure the safe usage of this product, carefully read and understand these instructions before operating your game. Save these instructions for future reference.

Use this product only as described in this manual. Other uses not recommended may cause fire, electric shock or personal injury. Unplug the game from the outlet when not in use, when moving from one location to another, and before cleaning/servicing.

Explanations which require special attention are indicated by signs of warning. Depending on the potential hazardous degree, the terms: **NOTE**, **NOTICE**, and **WARNING** are used.

NOTE: A NOTE indicates useful hints or information about product usage.

NOTICE: A NOTICE indicates potential damage to product and how to avoid the problem.

WARNING: A WARNING indicates a potential for product damage or serious personal injury.

It is important to understand the meaning of the following HAZARD SIGNS before continuing:



High Voltage and Shock Hazard:

High voltage can cause electric shock.
Turn off/unplug power before servicing.



High Temperature Hazard:

This part may cause scalding.
Do not touch. Surface may be hot.



Do Not Touch Hazard:

This may be hot or can cause electric shock.
Do not touch.

Use the following safety guidelines to help ensure your own personal safety and to help protect your equipment and surrounding environment from potential damage.

**THIS PRODUCT IS AN INDOOR MACHINE ONLY!
DO NOT INSTALL OUTDOOR!**



Avoid installing in the following places to prevent fire, electric shock, injury and/ or machine malfunctioning:

- Places subject to rain/moisture, or places subject to high humidity.
- Places subject to direct sunlight, or places subject to extremely hot or cold temperatures to ensure that it is used within the specified operating range.
- Places where inflammable gas may be present or in the vicinity of highly inflammable/ volatile chemicals or items that can easily catch fire
- On unstable or sloped surfaces. The machine may topple or cause unforeseen accidents.
- Vicinity of fire exist, fire extinguishers.

WARNING!

Non-technical personnel who do not have technical knowledge and experience should refrain from performing such work that this manual require or perform tasks which are not explained in this manual. Failing to comply can cause severe accidents such as electric shock or other serious injuries.

WARNING: To reduce the risk of fire, electric shock or personal injury, unplug or disconnect the machine from the power supply before servicing.

2. SPECIFICATIONS

Rated power supply:	110 - 240V (must be selected on power supplies)
Dimensions:	77 cm x 115 cm x 245 cm / 30,7" x 45,3" x
Weight:	150KG / 331 lbs 96,4"

NOTICE: After turning off the game, please wait at least 1 minute before restarting again.

Inspect Immediately after Transporting the Product After receiving the shipment, inspect the product thoroughly to ensure that it has been shipped with care. Before turning the power on, please check the following:

- Check the cabinet for damage or shifting that may have occurred during shipping. Are there any dented portions or defects (cuts, etc.) on the external surfaces of the cabinet?
- Are all the legs and adjusters/levelers/feet intact?
- Do the power supply voltage and frequency requirements meet with those of the location (110V/220V)? Are all wires linked correctly and securely connected to each other? If coupled in an incorrect manner, the connection will not be made accurately and it could cause not only irreparable damage to the machine, but also is a potential fire hazard. **DO NOT INSERT CONNECTORS FORCIBLY.**



- Check that the all the cables, including power cables, are undamaged. Do power cables or other wires have any splices, cuts, or dents?
- Have you been provided with all of the associated accessories?
- Can all doors/lids be opened with the accessory keys? Can doors/lids be firmly closed? Does the coin box key open the coin box(es)?

2.1 MAIN COMPONENTS

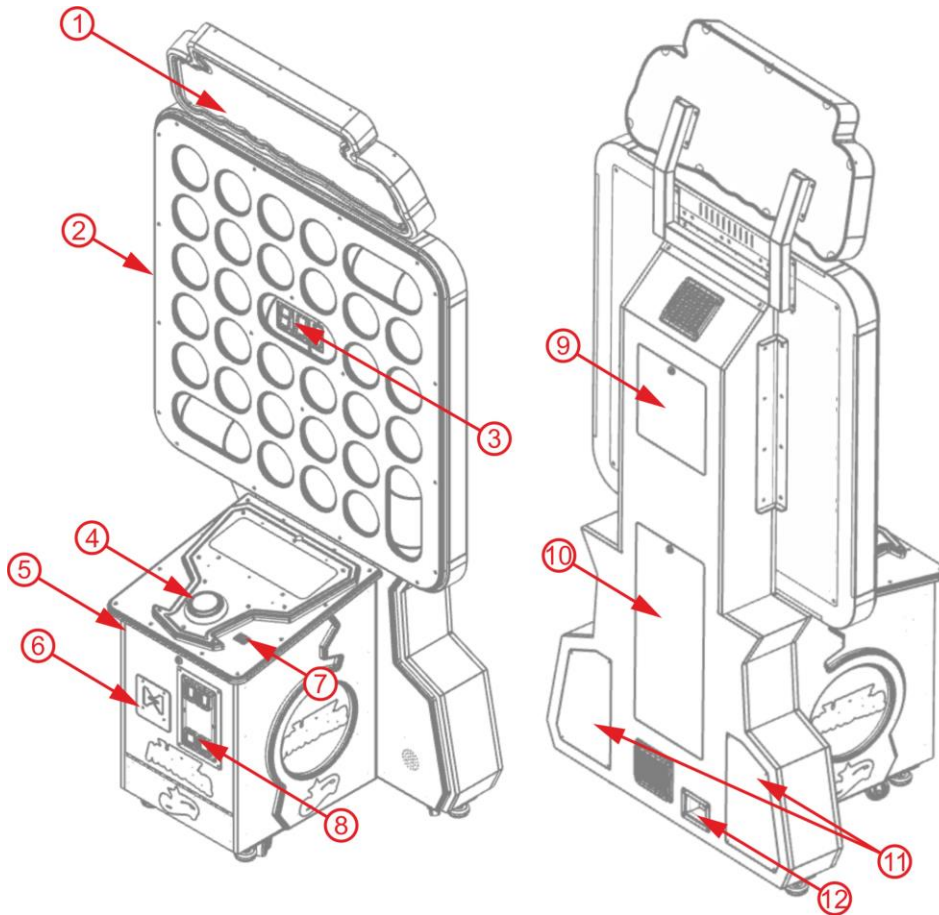

1. marquee
2. playfield
3. bonus display
4. START/STOP buton
5. front service door (setup panel access)
6. ticket dispenser out

7. credits display
8. coin acceptor panel
9. back service door 1 (assembly acces)
10. back service door 2 (main board access)
11. speaker service door
12. power socket



3. SETUP & INSTALLATION

- Refer to IMPORTANT SAFETY INSTRUCTIONS for places to avoid
- Place the unit on dry, leveled surface
- Ventilation openings in the back of the unit must not be obstructed by objects or by wall.

3.1 PLAY ZONE

This machine requires space for playing and for maintenance as shown below.

Leave space around the game upon instalation:

Service area: 50cm

Play area: 100cm

3.2 CONNECTING POWER

IMPORTANT!

POWER SUPPLY ADJUSTS AUTOMATICALLY TO 115V OR 230V

- Machines electrical system (power supplies and display) will adjust automatically to 230V or 115V voltage.
- Do not plug the equipment power cables into an electrical outlet if the power cable is damaged.
- Avoid putting many loads on one electrical outlet as it could generate heat the fire resulting from overload.

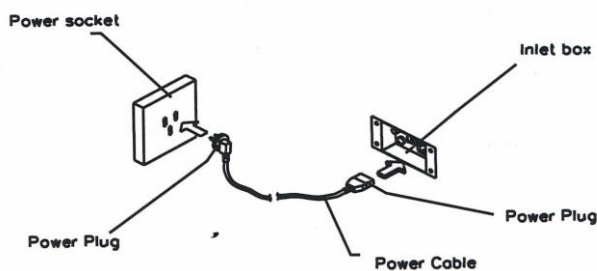

Connect the grounding conductor to the earth terminal (GND):

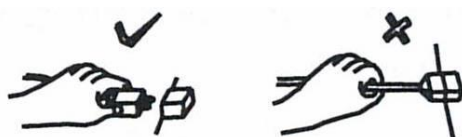

To disconnect the game, grip the plug and pull it from the wall outlet. Never pull by the cord.



Ensure that nothing rests on the power cord and that it is not located where it can be stepped on or tripped over.



To prevent electric shock, do not touch the power plug when hand is wet.



4. IMPORTANT INFORMATION AND GAMEPLAY

IMPORTANT!

DEVICE SOFTWARE IS COPYRIGHT PROTECTED. COPYING AND DISTRIBUTION IS STRICTLY PROHIBITED. IT IS ALSO FORBIDDEN TO INTERFERE IN THE INTEGRITY OF SOFTWARE THROUGH MODIFICATION OR IMPLEMENTATION OF ANY CHANGES WITHOUT APPROVAL OF THE MANUFACTURER. ANY ATTEMPTS OF SOFTWARE CHANGES, OTHER THAN THOSE SPECIFIED BY THE MANUFACTURER MAY RESULT IN WARRANTY LOSS.

4.1. SD CARD

The SD card contains audio sample files in MP3 format. There is one sound sample or each prize, and then some for pause, play and active (flash). Preferably, the MP3's should have a sample rate of 144kbps to 192kbps, but other rates may also function. If any of these files is missing at power-up, the display will show an error message.

Do NOT change the SD-card under power. Switch off first!

To access the micro-SD card, slide the silver cover approximately 1mm upwards until it hinges open. Install the micro-SD card exactly into the slots, keep it depressed there, then close the cover and slide it down. The micro-SD card must be formatted as FAT32, the most common format for these cards. FAT12, FAT16, NTFS, ExFAT and other formats are not supported. If necessary, reformat the disk on a Windows PC with a micro-SD slot or USB-interface, and force the PC to use FAT32 or use a special tool, e.g. from:

https://www.sdcard.org/downloads/formatter_4/

Cards with a capacity of 1 to 16GB (a.o. Lexar and Sandisk) have been successfully tested in the machine, and larger capacities should work as well. Note however that there may be cards for sale that do not work in embedded systems. It is strongly advised to first test a card before ordering a larger batch.



4.3 PLAYFIELD AND GAMEPLAY



1. Insert a coin and wait for the game to start
2. When the game starts, the player will hear the music assigned to the game mode, the START / STOP button will be illuminated and the bubbles on the playing field will light up one by one
3. The player's task is to press the START / STOP button when the bubble showing the ticket value that the player wants to win is highlighted
4. The player will receive the number of tickets shown on the illuminated bubble
5. If a player stops the game in the field labeled JACKPOT, he will be awarded the highest possible number of tickets for that field
6. If the player stops the game in the space labeled? MYSTERY VALUE, will receive a random number of tickets
7. If the player stops the game in the space labeled? 3 BONUS GAMES, will have the option to play 3 more games one after the other



5. GAME OPTIONS

5.1 MENU ACCESS AND NAVIGATION

To access menu press ENTER/SELECT button, located in service door, at the lower front of the machine, next to the coin and ticket counters.

Use UP/+ and DOWN/- buttons to navigate in the menu. Use ENTER/SELECT to ENTER or SELECT the option value or selection



IMPORTANT!

REMEMBER THAT CHANGES IN THE SERVICE MENU CAN RELATE TO ELEMENTS SUCH AS THE COST OF THE GAME AND THE NUMBER OF WON TICKETS, AND WHICH MAY AFFECT THE EARNINGS OF THE DEVICE. MAKE SURE THAT THE CHANGES AND ENTERED VALUES ARE VALID.



5.2 SERVICE MENU

MAIN MENU			
Game Version: 2.X.X d1.X.X	Indicates software version, „d” is front screen software version		
1. DEVICE SETTINGS	1. MUSIC VOLUME	0-100	Set music volume
	2. DEMO VOLUME	0-100	Set demo volume
	3. DEMO INTERVAL	0-60 minutes	Set demo frequency, 0=no delay.
2. GAME SETTINGS	1. AUTOSTART	ON / OFF	Start game without start button push
	2. AVG TIC/GAME	10-100	Set expected ticket revenue
	3. DIFFICULTY	1-9	Set game difficulty
	4. TMAX[ms]	50-200	Set max light time of pole.
	5. TMIN[ms]	4-50	Set min light time of pole.
	6. JACKPOT MIN	1-999	Set START value for jackpot
	7. JACKPOT ADD	0-999	Set ADD value for jackpot
	8. JACKPOT MAX	1-999	Set MAX value for jackpot
	9. JACKPOT RST		Reset jackpot to START value
	10. MYSTERY VALUE	1-999	Set ticket value for MYSTERY VALUE pole.
3. CREDIT SETTINGS	1. SERVICE GAME	ON / OFF	Play service game, no credits needed
	2. GAME PRICE	1-10	How many credits needed to play 1 game
	3. CLEAR COINS		Reset game credits
	4. COIN CH1/BILL VALUE	1-50	Value of CH1 and Pulse coin acceptor & bill acceptor & for counters
	5. COIN CH2 VALUE	1-50	Value of CH2 coin acceptor & for counters
	6. COIN CH3 VALUE	1-50	Value of CH3 coin acceptor & for counters
	7. COIN CH4 VALUE	1-50	Value of CH4 coin acceptor & for counters
4. TICKET SETTINGS	1. TICKET	ON / OFF	
	2. CLRundispTICK		Reset undispensed tickets
	3. TICKETS DEVICE	- ENTROPY TD-963CR	default: ENTROPY TD-963CR
	4. TICKET VALUE	1, 2	Change won tickets value
5. COUNTERS	1. RESETABLE	1. CREDITS	Total coins
		2. GAMES	Total games
		3. TICKETS	Total tickets given
	2. NON-RESETABLE	1. COINS	Total coins
		2. GAMES	Total games
		3. TICKETS	Total tickets given
6. STATS	1. AVERAGE TICKETS WIN		Show average tickets win
	2. JACKPOT COUNT		Show JACKPOT wins count
	3. MYSTVAL COUNT		Show MYSTERY VALUE wins count
7. TESTS	1. DISPLAY TEST		Game board test
	2. JACKDIS TEST		Test jackpot display
	3. COIN TEST		Check coin acceptor
	4. STARTB TEST		Check start button
	5. DISP10TICKET		Dispense 10 tickets
8. FACTORY SETTINGS			Reset to factory settings
9. SAVE & EXIT			Save changes and exit



6. MAINTENANCE, INSPECTION

6.1 SAFETY CHECK

Check the points listed before operating the machine. These checks are necessary for safe machine operation:

1. Try to run the game before operation each day.
2. Conduct monthly routine checks of game components to ensure good working condition
3. Check the machine regularly for dust and clean when necessary.

Note : Parts and components require preventative maintenance to be kept running smoothly

7. TROUBLESHOOTING

Ticket dispensing is not working

1. Check Ticket settings in service menu and make sure that they are turned ON, and proper ticket dispenser is selected
2. Check ticket dispenser wiring and connections
3. Check ticket dispenser

Coin acceptor/bill acceptor is not working

1. Check Credit settings in service menu and make sure that everything is set properly
2. Check coin/bill acceptor wiring and connections
3. Check coin/bill acceptor

No sound

1. Check Device settings in service menu
2. Check speakers wiring and connections

Plugged in and nothing happened

1. Check power wiring
2. Check power supplies placed behind front-central doors – green LED light means OK
3. Check power supplies voltage-input settings. You need to choose between 115/230V before being operational. We set it to default voltage for country of machine destination.
4. Check main board or replace



8. TERMS OF WARRANTY

Magic Play Sp. z o.o. warrants that the LUCKY NUMBERS game will be free from electrical and mechanical defects for a period of 12 months from the date of delivery.

Warranty covers:

- Display
- CPU board
- I/O board
- Power supplies
- LED driver
- LED lighting

Warranty terms do not cover parts not included above.

Definition of defect:

It will be considered as defective if any connection between subcomponents on a particular board fails or any of them stops working itself. It does not include damages which occurred due to misuse, unauthorized connection or modifications.

Should the product prove defective during the warranty period, Magic Play, at its option, shall:

1. Repair the defective part by means of telephone support or depot service at no charge for parts or labor.
2. Replace the defective part with a comparable product which may be new or refurbished.

Provided that

1. Magic Play is informed of the defect immediately after it occurred. The faulty part should be dispatched to Magic Play or its authorized distributor as soon as possible.
2. Magic Play diagnoses the defects were not caused by improper use, neglect, unauthorized modifications, repair, setup or testing.
3. Only parts recommended and approved by Magic Play are covered by Magic Play Terms of Warranty.

**UNDER NO CIRCUMSTANCES SHALL MAGIC PLAY SP. Z O.O. BE HELD RESPONSIBLE FOR
LOSSES IN PROFIT, USAGE OR ACCIDENTAL SERIOUS DAMAGE TO THE MACHINE!**

Magic Play sp. z o.o.

Address: Chocimska 6

62800 Kalisz, POLAND

Phone: +48 62 753 21 88

Website: www.magicplay.eu